



SAMUEL MAHELONA MEMORIAL HOSPITAL TOD MASTER PLAN UPDATE

COMMUNITY MEETING
DRAFT CONCEPTUAL MASTER PLAN
JANUARY 11, 2023



PROJECT OVERVIEW

2020 SMMH MASTER PLAN (G70)

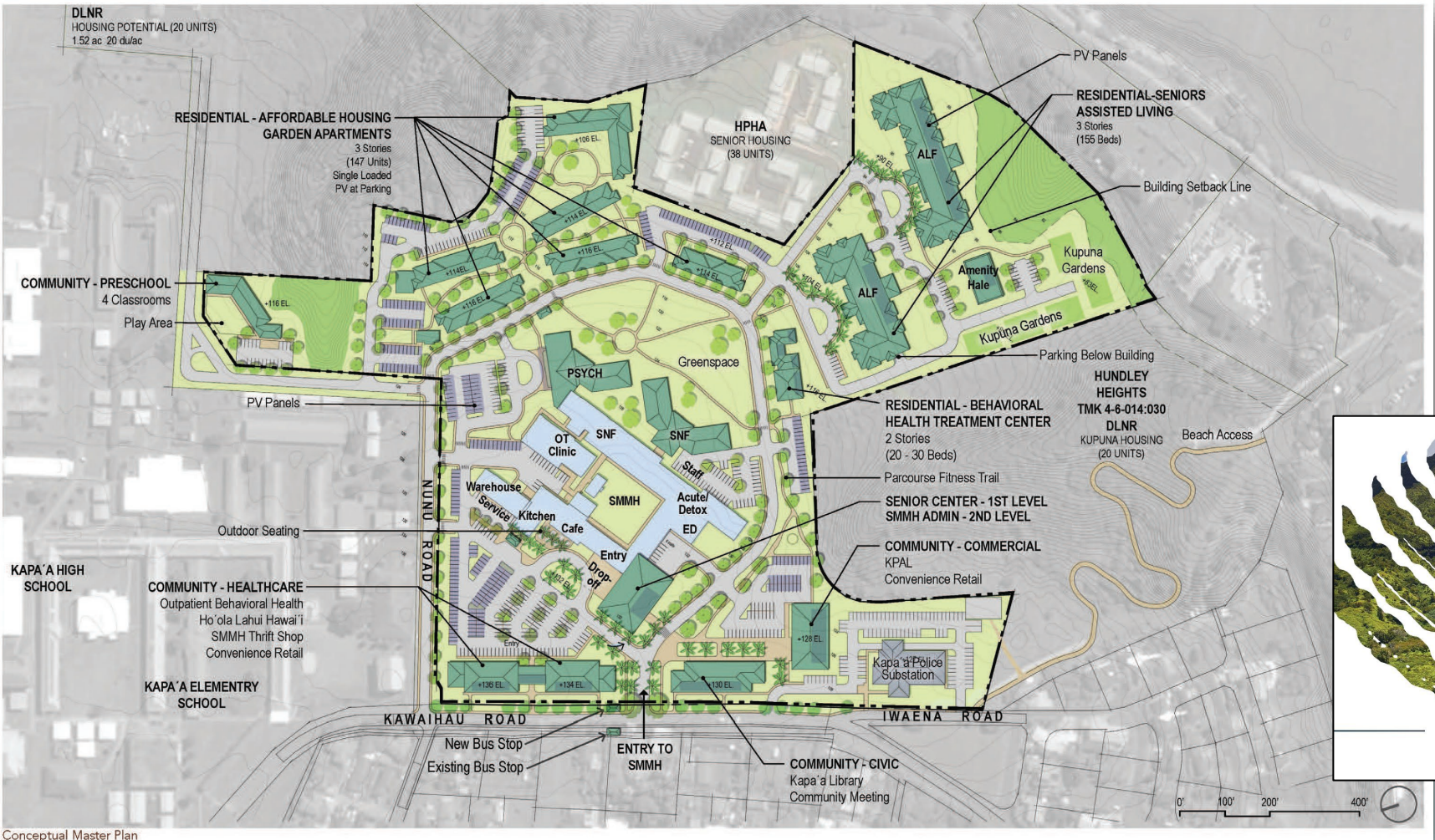

Conceptual Master Plan

HAWAII HEALTH SYSTEMS CORPORATION
KAUAI REGION
E PONO MAU LOA
Healed Through Kindness

**SAMUEL MAHELE MEMORIAL HOSPITAL
CONCEPTUAL MASTER PLAN**

NOVEMBER 2020

G70

2020 SMMH MASTER PLAN PRIORITIES

- Senior Care
 - Behavioral Health Care
 - Affordable Housing
 - Multi-Generational and Multi-Use Healthcare Wellness Village
 - Resilient and Sustainable Campus
 - Increase Property Utilization using Smart Growth principles that support transit-oriented development (TOD)
 - Incorporate Adjacent State Lands to Support the Community
 - Partnerships with Private, County and State Organizations
 - Expanded, Convenient and Accessible Community Amenities
- 
- A decorative graphic in the bottom right corner consisting of several overlapping, stylized leaf shapes in a light teal color, pointing upwards and to the right.

CURRENT TOD SCOPE OF WORK

- Update 2020 Master Plan for SMMH
- Explore TOD (Transit-Oriented Development) opportunities to better connect to the 4 adjacent State parcels, schools, and community
- Hospital program remains unchanged
- Programmatic EIS
- Kapa'a Public Library relocation
- New Police Substation



PROJECT TIMELINE (UPDATED)





**CONCEPTUAL
DESIGN
ALTERNATIVES**
(MAY 2022)

OPTIONS COMPARISON

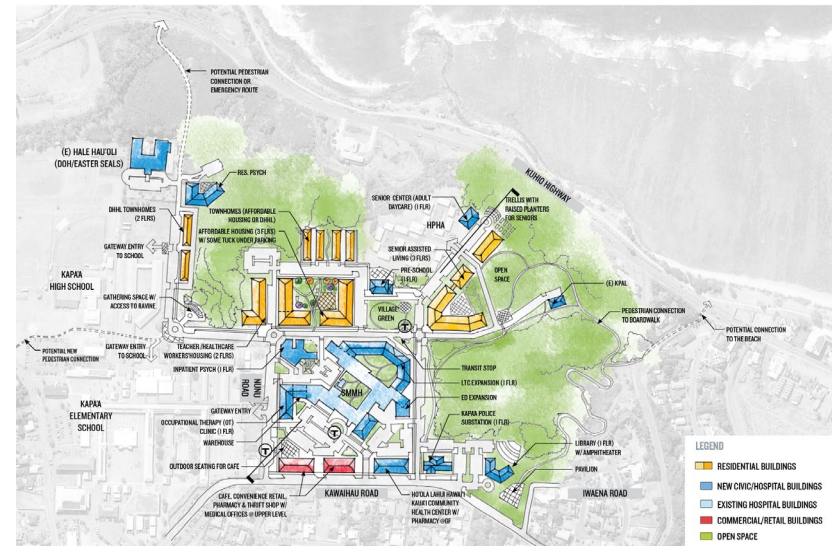

Option A: Main Street with Village Green

- Compact hospital campus with pedestrian-oriented “main street” along Kawaihau Rd.
- Network of walkways connecting the boardwalk, village green, and bluff park
- Library and triangular park at Iwaena Rd.
- Teacher/healthcare workers’ and DHHL housing, residential psych and Easter Seals facility along Nunu Rd.

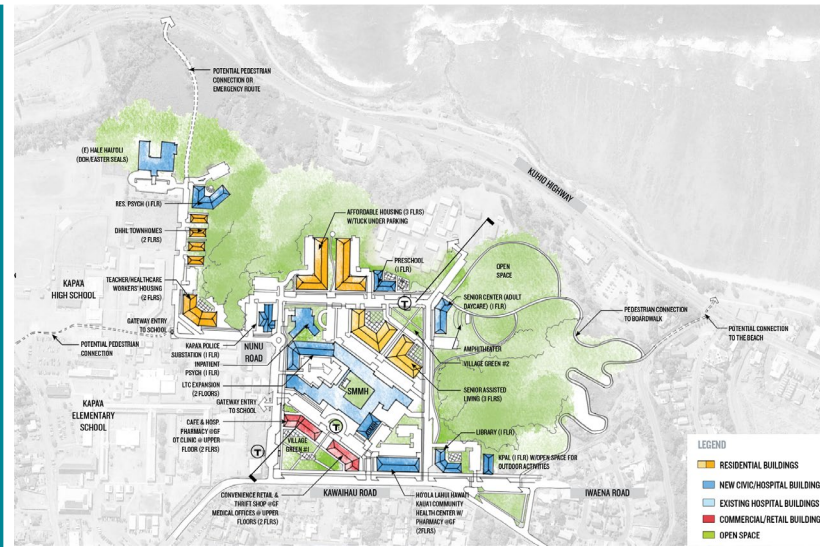

Option B: Duo Village Greens

- Dual village greens at opposite ends of a loop road and senior assisted living overlooking a large bluff park.
- Community retail and medical uses along Kawaihau Rd.
- Kapa’a Police Substation and other housing uses along Nunu Rd.

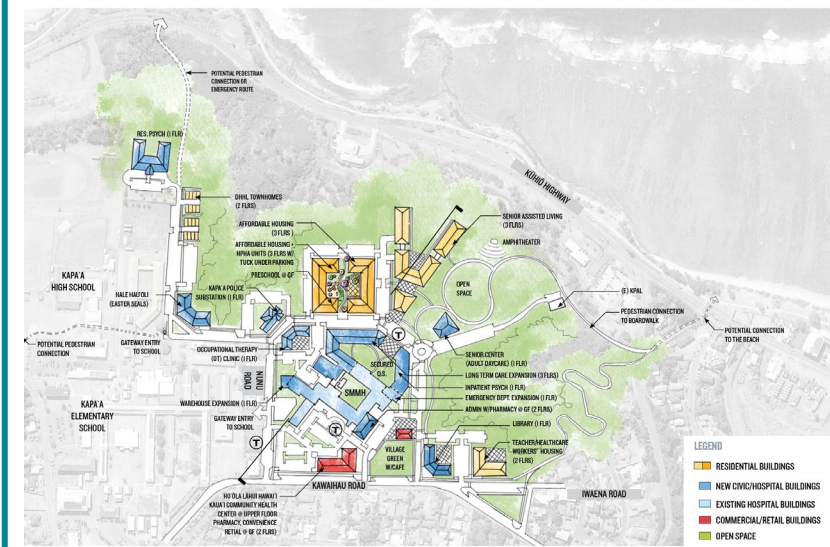

Option C: The Bluff

- Compact hospital campus with village green, retail, library, teacher/healthcare workers’ housing along Kawaihau Rd.
- Senior assisted living and senior center at the large bluff park with amphitheater.
- Kapa’a Police Substation, DHHL housing, new residential psych and new Easter Seals facility along Nunu Rd.



**DRAFT
CONCEPTUAL
MASTER PLAN**

- LEGEND**
- HOSPITAL BUILDINGS / PUBLIC FACILITIES
 - HOUSING
 - COMMERCIAL BUILDINGS
 - ROADWAYS
 - PARKING AREAS / DRIVEWAYS
 - COMMUNITY SPACE
 - SIDEWALKS / PEDESTRIAN PATHS
 - EXISTING BUS STOP
 - TRANSIT HUB
 - EXERCISE STATION





**TALK STORY
TIME / Q&A**



MAHALO!

Visit the project website at:

WWW.PLANMAHELONA.COM

Email us at:

PLANMAHELONA@GMAIL.COM

Call us at:

LANCE SEGAWA (HHSC) – (808) 338-9222

TY SHIRAMIZU (PBR) – (808) 521-5631 X39